

INTERMEDIATE
SKILL

Bird in Hand

designed by Wendy Sheppard
featuring the *Handsome* collection by Whistler Studio

SIZE: 62-1/2" x 62-1/2"

PATTERN REQUIRES APPLIQUÉ TECHNIQUE.

FREE
PROJECT







THIS IS A DIGITAL REPRESENTATION OF THE QUILT TOP, FABRIC MAY VARY.

PLEASE NOTE: BEFORE MAKING YOUR PROJECT, CHECK FOR ANY PATTERN UPDATES AT WINDHAMFABRICS.COM'S FREE PROJECTS SECTION.

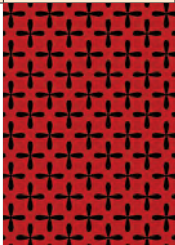
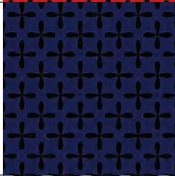

Bird in Hand

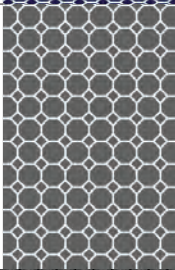
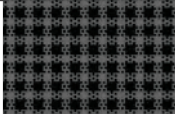
WOF = Width of Fabric

KEY	FABRIC	SKU	YD	CUTTING INSTRUCTIONS
A		51337-1 Red	7/8	Binding: (7) 2-1/4" x WOF strips. Lone Star Template: (4) pieces each of 3 and 4. Flower Template: (15) pieces of appliqué 8. Bird Beak and Wing Template: (1) each.
B		51337-2 Navy	1/2	Lone Star Template: (8) pieces each of 3 and 4. (6) 1" x WOF strips. Piece strips and subcut (2) 1" x 54-1/2" and (2) 1" x 55-1/2" strips.
C		51337-3 Grey	1/4	(1) 5-1/2" x WOF strip; subcut (8) 3" x 5-1/2" rectangles.
D		51337-4 Ash	1/4	Lone Star Template: (8) pieces each of 3 and 4.
E		51338-2 Navy	5/8	Lone Star Template: (12) pieces each of 3 and 4. (1) 5-1/2" x WOF strip; subcut (8) 3" x 5-1/2" rectangles.
F		51338-3 Grey	1-1/8	Lone Star Template: (4) pieces each of 3 and 4. (1) 6" x WOF strip; subcut (2) 6" squares and (8) 3" x 5 1/2" rectangles. (7) 3" x WOF strips. Piece strips and subcut (2) 3" x 58" and (2) 3" x 63" strips.
G		51339-3 Grey	1/4	(1) 5-1/2" x WOF strip; subcut (8) 3" x 5-1/2" rectangles.
H		51339-6 Brown	1/8	Flower Template: (15) pieces each of 7 (stem).

PROJECT DISCLAIMER: Every effort has been made to ensure that all projects are error free. All the information is presented in good faith, however, no warranty can be given nor results guaranteed. Therefore, we assume no responsibility nor damages that may occur when referring to this pattern. When errors are brought to our attention, we make every effort to correct and post a revision as soon as possible. We suggest you check windhamfabrics.com for pattern updates and to test the pattern prior to making the project. **Test templates first, before cutting all the pieces. Free projects are not for resale.**



Bird in Hand

WOF = Width of Fabric

KEY	FABRIC	SKU	YD	CUTTING INSTRUCTIONS
I		51340-2 Navy	5/8	<p>Flower Template: (15) pieces each of 9.</p> <p>Bird Body Template: (1) piece.</p> <p>(4) 1" x WOF strips; subcut (2) 1" x 39-1/2" and (2) 1" x 40-1/2" strips.</p> <p>(1) 5-1/2" x WOF strip; subcut (8) 3" x 5-1/2" rectangles.</p>
J		51341-7 White	3-1/8	<p>Lone Star Template: (12) pieces each of 3 and 4. (8) pieces of each 1 and 2.</p> <p>(4) 2" x WOF strips; subcut (2) 2" x 36-1/2" and (2) 2" x 39-1/2" strips.</p> <p>(10) 3" x WOF strips; subcut (132) 3" squares.</p> <p>(1) 6" x WOF strip; subcut (2) 6" squares.</p> <p>(6) 2-1/2" x WOF strips. Piece strips and subcut (2) 2-1/2" x 50-1/2" and (2) 2-1/2" x 54-1/2" strips.</p> <p>(6) 1-3/4" x WOF strips. Piece strips and subcut (2) 1-3/4" x 55-1/2" and (2) 1-3/4" x 58" strips.</p>
K		51342-2 Navy	3/8	<p>Flower Template: (15) pieces each of 5 and 6 (leaves).</p> <p>(1) 5-1/2" x WOF strip; subcut (8) 3" x 5-1/2" rectangles.</p>
L		51342-4 Ash	5/8	<p>Lone Star Template: (16) pieces each of 3 and 4.</p> <p>(1) 5-1/2" x WOF strip; subcut (8) 3" x 5-1/2" rectangles.</p>
M		51342-8 Charcoal	1/4	<p>(1) 5-1/2" x WOF strip; subcut (8) 3" x 5-1/2" rectangles.</p>
		Backing	4	Batting: 69" x 69"

Other Materials: Plastic for templates, paper-backed fusible web and matching threads.



Bird in Hand

LONE STAR BLOCK

Press seams open unless otherwise stated. All seams are 1/4".

Appliqués: Reference your favorite quilting source for hand or machine appliqué.

1. **Block Quadrant:** Arrange and sew together (4) pieces of Lone Star Template (LST) 4 to make a row. Sew the (4) rows together. Use the following fabrics for each row.

Row 1: **F, D, J, L** Row 2: **D, J, L, E** Row 3: **J, L, E, B** Row 4: **L, E, B, A**

2. Sew (1) LST 1 triangle, short side, to the left of Row Units, followed by (1) LST 2 triangle, long side, to the top of Row Units as shown.
3. Repeat to make a mirror-imaged using Lone Star Template 3 pieces. Sew the LST 1 and 2 triangles as shown.
4. Sew both units from Steps 2 and 3 to complete (1) Block Quadrant. Note rotation. Make (4).
5. Lone Star Block: Noting rotation, sew together Block Quadrants. Square to 36-1/2".

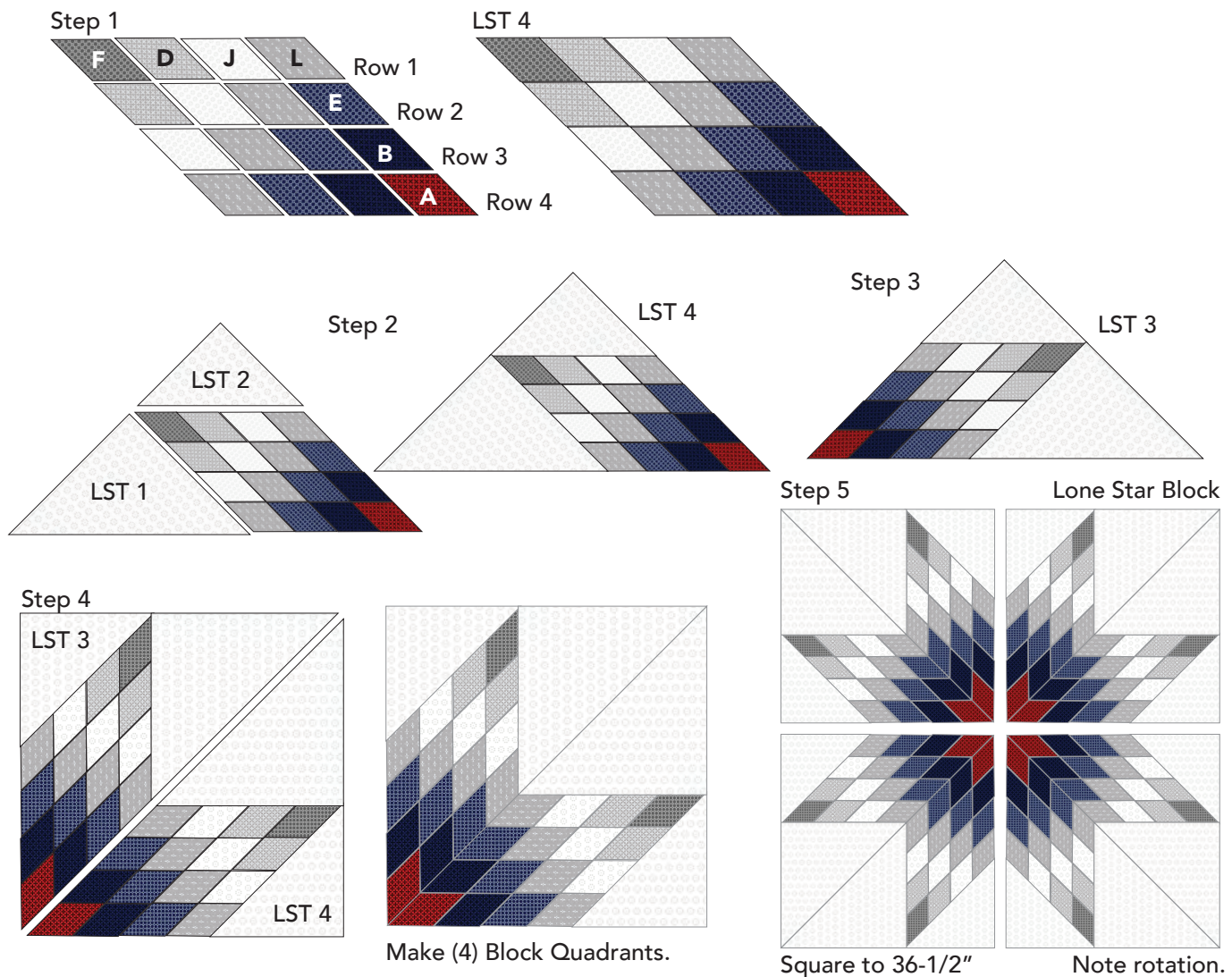



Bird in Hand

6. Referring to the quilt image, arrange **Floral Wreaths (A, H, I and K)** and **Bird (A and I)** appliqué pieces on the **Lone Star Block**. Fuse, baste or pin the pieces in place. Attach pieces using method of choice.



PIECED BORDER BLOCK

7. Draw a diagonal line on the wrong side of (1) **J** 3" square. Place square, right sides together, at a corner of (1) **C** 3" x 5-1/2" rectangle. Sew on drawn line. Trim 1/4" away from sewn line. Open and press to reveal **J** corner triangle. Repeat with another **J** square at the diagonally opposite corner of **C**. Make a mirror-imaged unit. Sew both units together to complete (1) Pieced Block.
8. Using **J** 3" square, make (4) each of the following Pieced Blocks: **C, E, F, G, I, K, L** and **M**. Set aside for later use.

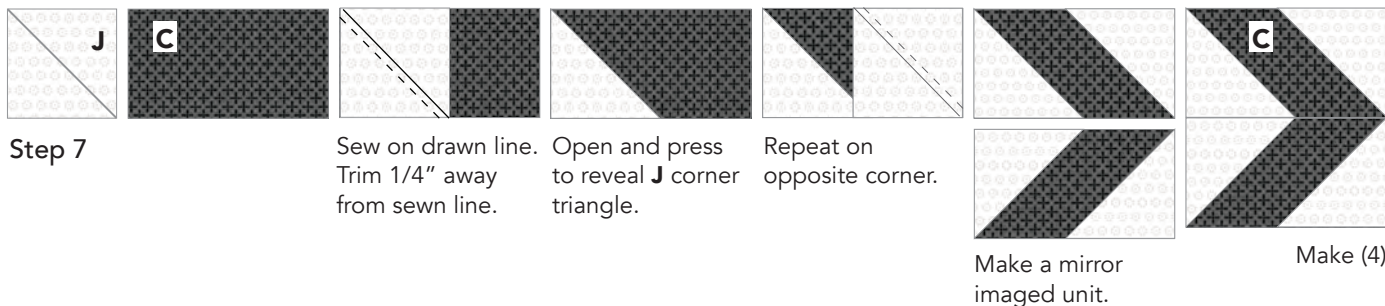



Bird in Hand

CORNER BLOCK

9. Draw a diagonal line on the wrong side of (1) **J** 6" square. Place square, right sides together, on (1) **F** 6" square. Sew 1/4" away on both sides of drawn line. Cut along drawn line to yield (2) half-square triangle (HST) units. Align diagonal seam of HST units against 45° degree line on quilting ruler, trim units to measure 5-1/2" square.
10. Draw a diagonal line on the wrong side of (1) **J** 3" square. Place square, right sides together, at the corner where **F** patch is in the previously sewn HST unit. Sew on drawn line. Trim 1/4" away from sewn line. Open and press to reveal **J** corner triangle. Make (4) **Corner Blocks** and set aside for later.

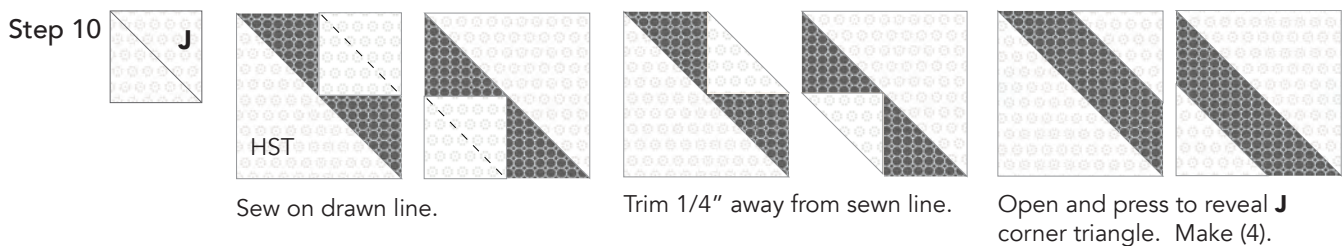
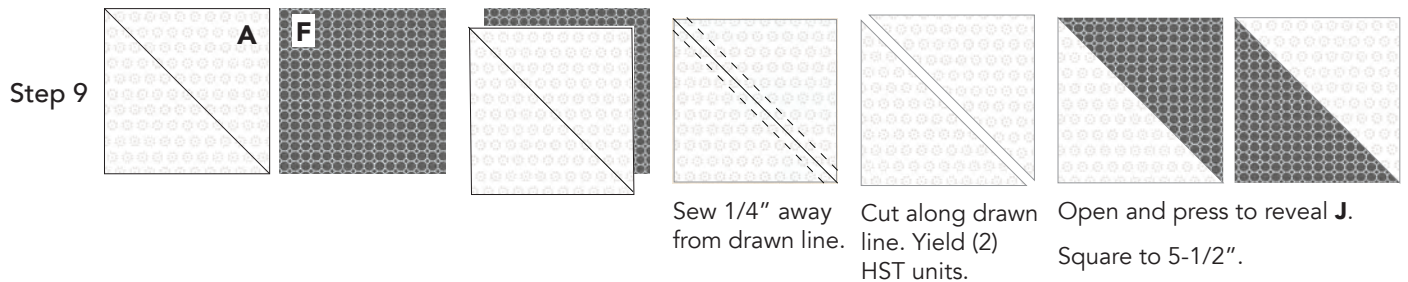

BORDERS

11. Inner Border 1: Sew (2) **J** 2" x 36-1/2" strips to the sides of **Quilt Center**, followed by (2) **J** 2" x 39-1/2" strips to the top and bottom sides.
12. Inner Border 2: Sew (2) **I** 1" x 39-1/2" strips to the sides of **Quilt Center**, followed by (2) **I** 1" x 40-1/2" strips to the top and bottom sides.
13. Inner Border 3: Arrange and sew together (8) **Pieced Border Blocks** (Steps 7-8), as shown, to make a column unit. Note rotation of units. Make (4). Sew (2) to the sides of **Quilt Center**.
14. Add (2) **Corner Blocks** to the opposite short ends of the (2) remaining column units from Step 13. Note rotation. Make (2) and sew to the top and bottom of **Quilt Center**.

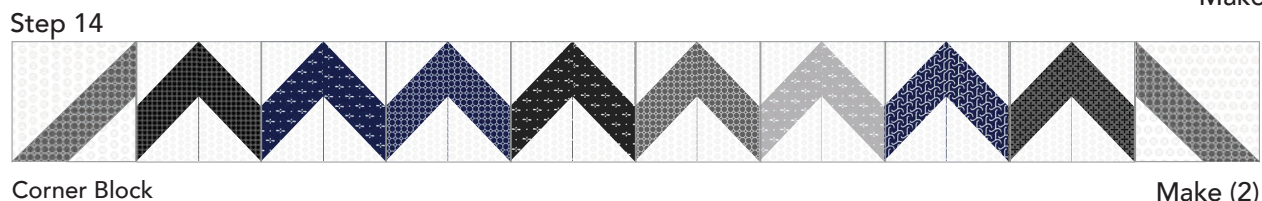
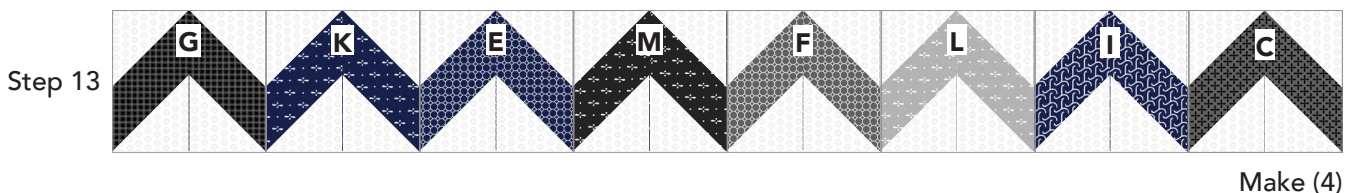



Bird in Hand

15. Inner Border 4: Sew (2) **J** 2-1/2" x 50-1/2" strips to the sides of Quilt Center, followed by (2) **J** 2-1/2" x 54-1/2" strips to the top and bottom sides.
16. Inner Border 5: Sew (2) **B** 1" x 54-1/2" strips to the sides of Quilt Center, followed by (2) **B** 1" x 55-1/2" strips to the top and bottom sides.
17. Inner Border 6: Sew (2) **J** 1-3/4" x 55-1/2" strips to the sides of Quilt Center, followed by (2) **J** 1-3/4" x 58" strips to the top and bottom sides.
18. Outer Border: Sew (2) **F** 3" x 58" strips to the sides of Quilt Center, followed by (2) **F** 3" x 63" strips to the top and bottom sides.

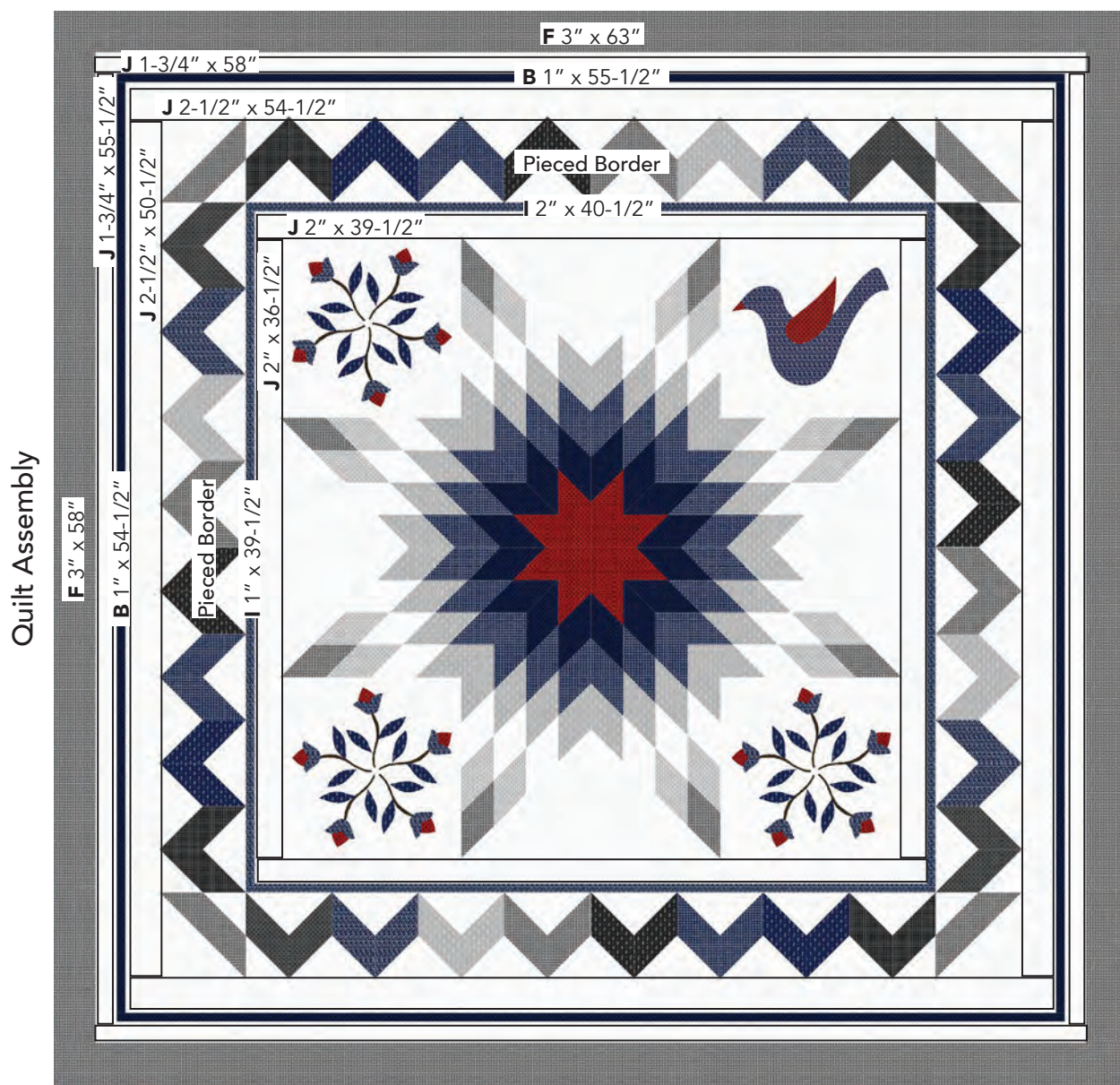

FINISHING: Layer quilt top, batting and backing together to form quilt sandwich. Baste and quilt as desired. Bind using **A** 2-1/4" strips.



LONE STAR TEMPLATE

Bird in Hand

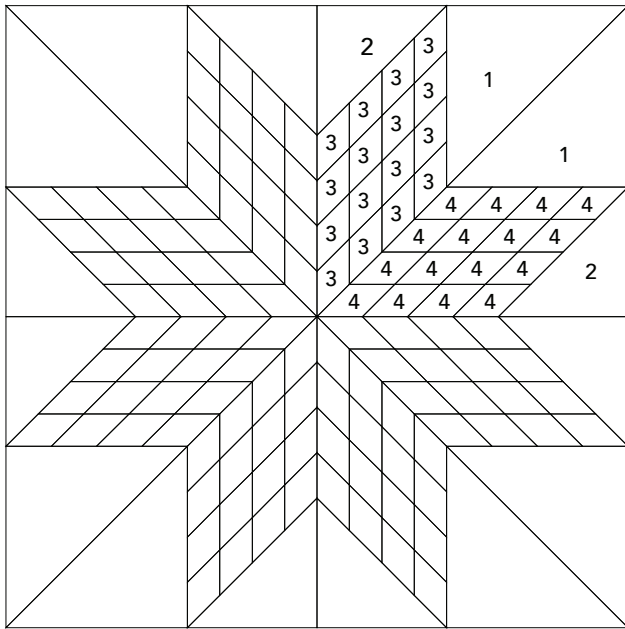

Print Templates at 100% scale.
Trace templates 1-4 onto plastic
template material and cut out.

Triangle 1 Bottom

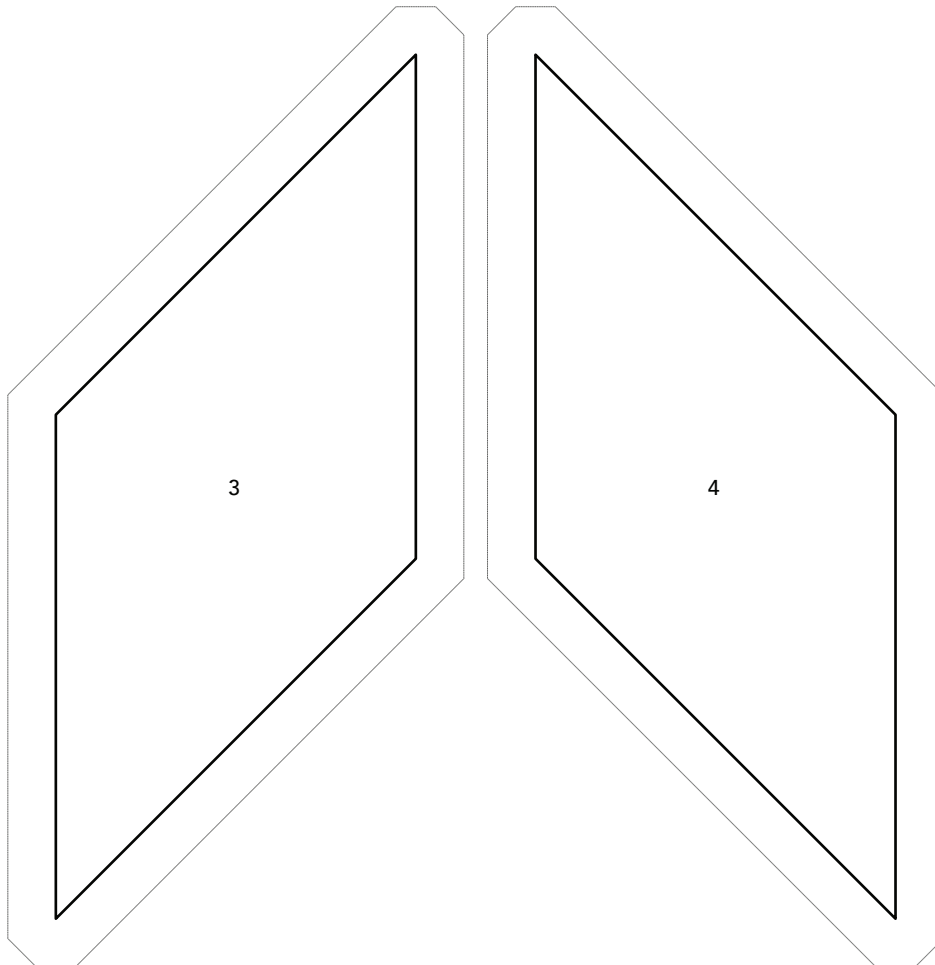
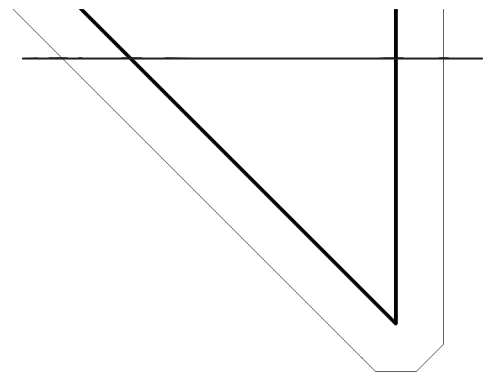



Bird in Hand

Align with Triangle 1 (Top).
Tape together, and trim shape
to complete the template.

Triangle 1 Template

Triangle 1 Top

Note: This template is reversed.

Align with Triangle 1 (Bottom).
Tape together, and trim shape
to complete the template.

1"

Print Templates at 100% scale.
Trace templates 1-4 onto plastic
template material and cut out.



Bird in Hand

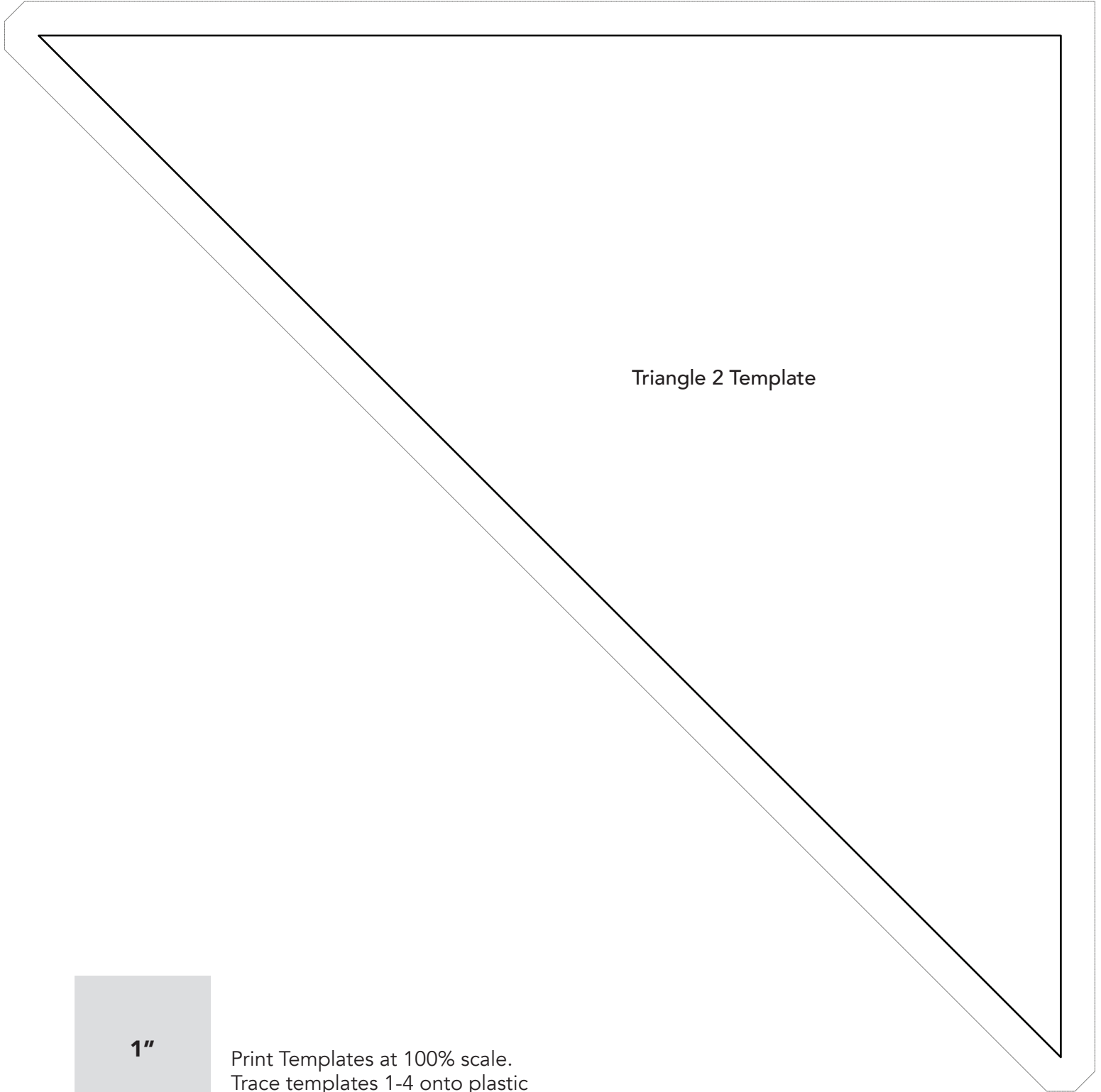

1"

Print Templates at 100% scale.
Trace templates 1-4 onto plastic
template material and cut out.



FLOWER WREATH TEMPLATE

Bird in Hand

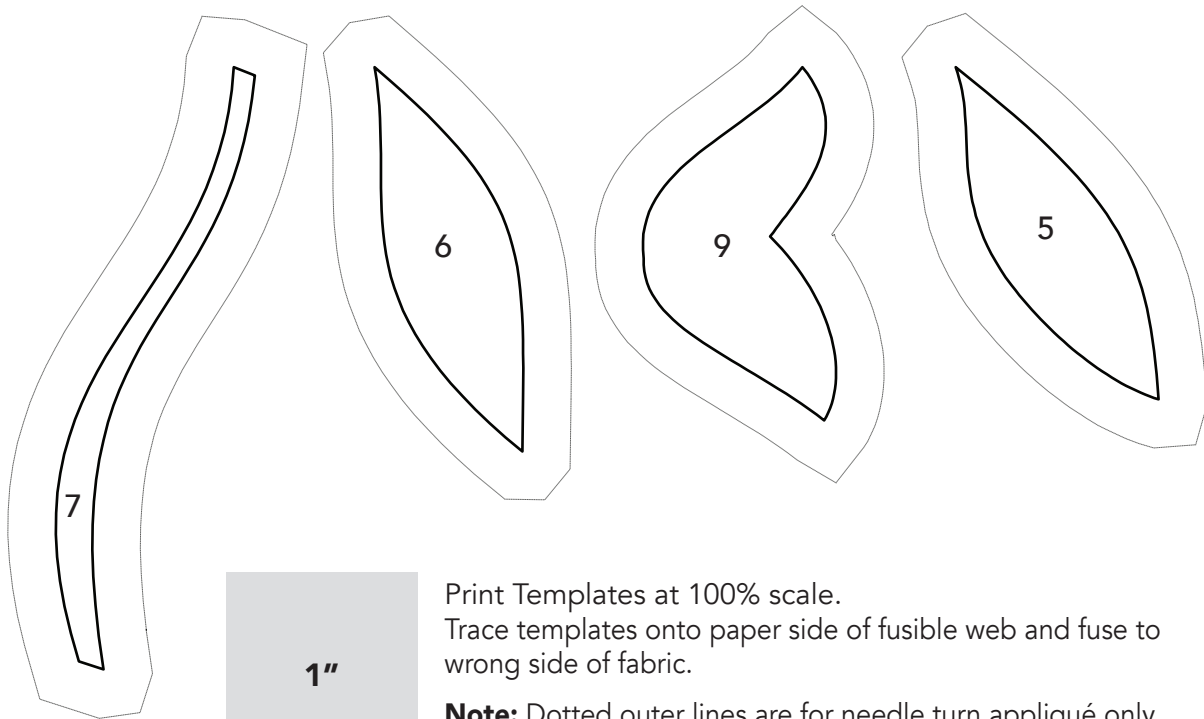
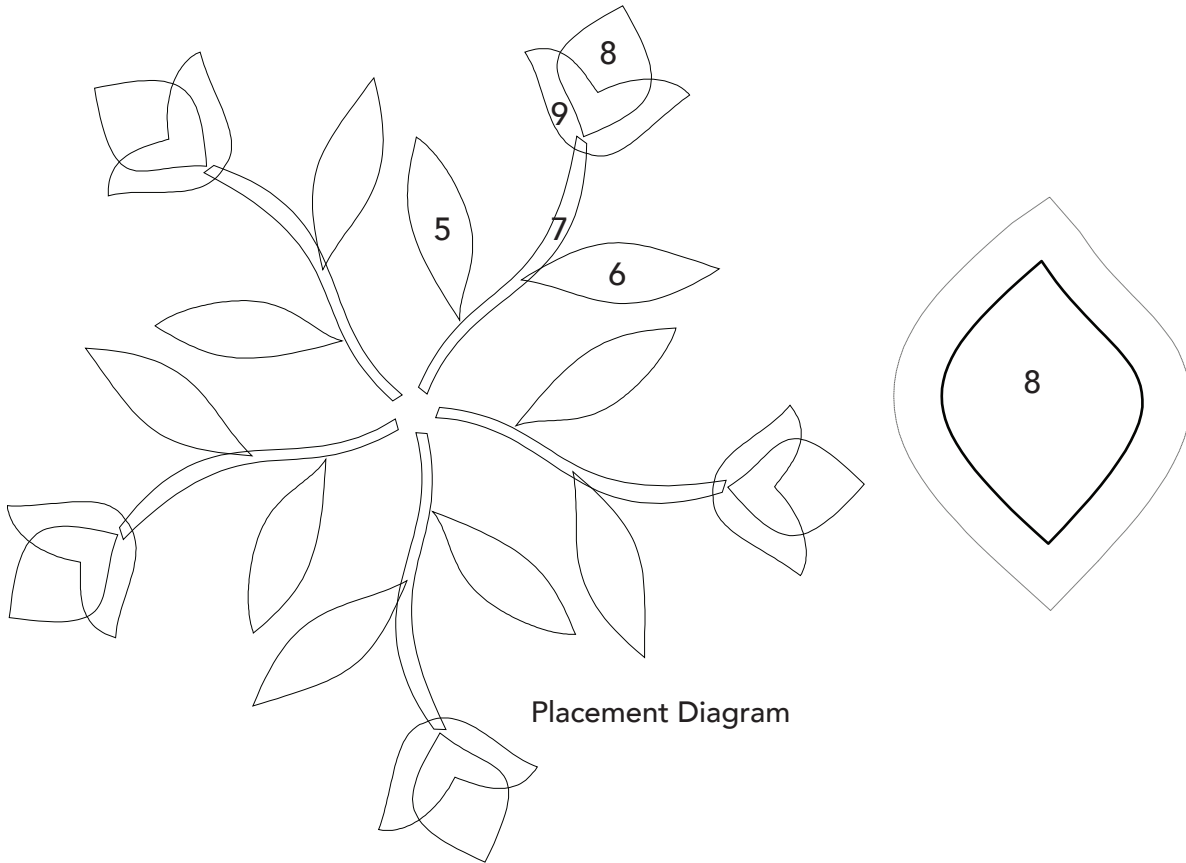

Print Templates at 100% scale.
Trace templates onto paper side of fusible web and fuse to wrong side of fabric.

Note: Dotted outer lines are for needle turn appliqué only.
Trace on solid line for fusible appliqué.



BIRD TEMPLATE

Bird in Hand

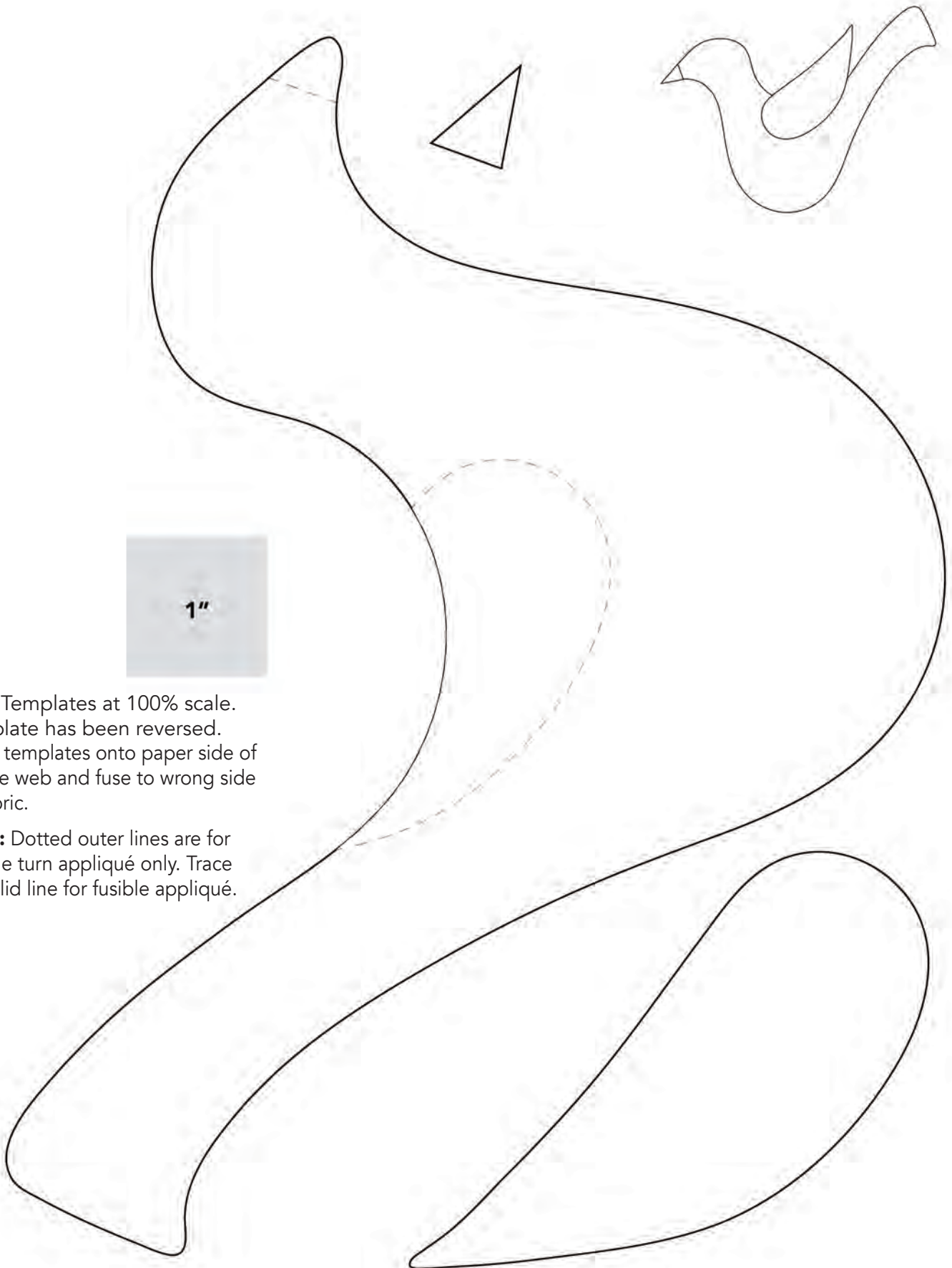

1"

Print Templates at 100% scale.
Template has been reversed.
Trace templates onto paper side of
fusible web and fuse to wrong side
of fabric.

Note: Dotted outer lines are for
needle turn appliqué only. Trace
on solid line for fusible appliqué.