

INTERMEDIATE
SKILL

Field of Tulips

designed by Wendy Sheppard
featuring *Fairfield* by Whistler Studios

SIZE: 65" x 72-1/2"

FREE
PROJECT



THIS IS A DIGITAL REPRESENTATION OF THE QUILT TOP, FABRIC MAY VARY.

PLEASE NOTE: BEFORE MAKING YOUR PROJECT, CHECK FOR ANY PATTERN UPDATES AT WINDHAMFABRICS.COM'S FREE PROJECTS SECTION.



Field of Tulips

PROJECT DISCLAIMER: Every effort has been made to ensure that all projects are error free. All the information is presented in good faith, however, no warranty can be given nor results guaranteed. Therefore, we assume no responsibility nor damages that may occur when referring to this pattern. When errors are brought to our attention, we make every effort to correct and post a revision as soon as possible. We suggest you check windhamfabrics.com for pattern updates and to test the pattern prior to making the project. Test templates first, before cutting all the pieces. Free projects are not for resale.

HST = Half Square Triangle / QST= Quarter Square Triangle / WOF = Width of Fabric

KEY	FABRIC	SKU	YD	CUTTING INSTRUCTIONS
A		53544-5 Canvas	3-1/4	<p>PIECED BLOCKS (1) 8" x WOF strip; subcut (20) 1-1/2" x 8" rectangles. (4) 3-1/2" x WOF strips; subcut (40) 3-1/2" x 3-3/4" rectangles. (3) 2-1/2" x WOF strips; subcut (40) 2-1/2" squares. (5) 1-1/2" x WOF strips; subcut (120) 1-1/2" squares. (2) 1-1/4" x WOF strips; subcut (40) 1-1/4" squares.</p> <p>FLOWER BLOCK UNITS: (1) 2-1/2" x WOF strip; subcut for STAR: (1) 2-1/2" and (2) 2" squares. Cut 2-1/2" squares diagonally twice for a total of (4) QSTs, and cut 2" squares diagonally once for a total of (4) HSTs. SHOOFLY: (2) 2-1/4" and (1) 1" squares. CHURN DASH: (2) 2" squares and (4) 1" x 1-1/2" rectangles. CROSS: (4) 1-1/2" squares.</p> <p>SASHING BLOCKS: (26) 1-1/2" x WOF strips. Reserve for strip piecing with G. CORNERSTONES: (6) 1-1/2" x WOF strips. Reserve for strip piecing with G. INNER BORDER 1: (7) 2-1/2" x WOF strips. Piece strips and subcut (2) 2-1/2" x 63-1/2" and (2) 2-1/2" x 60" strips.</p>
B		53540-2 Denim	1/3	<p>PIECED BLOCKS (1) 7-1/2" x WOF strip; subcut (3) 7-1/2" x 8" and (9) 1-1/2" x 3" rectangles.</p>
C		53540-4 Khaki	3/4	<p>OUTER BORDER: (7) 3" x WOF strips. Piece strips and subcut (2) 3" x 67-1/2" and (2) 3" x 65" strips.</p>
D		53541-2 Denim	1/3	<p>PIECED BLOCKS (1) 7-1/2" x WOF strip; subcut (3) 7-1/2" x 8" and (9) 1-1/2" x 3" rectangles.</p>
E		53541-3 Light Wash	3/8	<p>PIECED BLOCKS (2) 3-1/2" x WOF strips; subcut (18) 3-1/2" squares. (1) 1-1/2" x WOF strip; subcut (9) 1-1/2" x 3-1/2" rectangles.</p>



Field of Tulips

HST = Half Square Triangle / QST= Quarter Square Triangle / WOF = Width of Fabric

KEY	FABRIC	SKU	YD	CUTTING INSTRUCTIONS
F		53542-3 Light Wash	1/2	<p>PIECED BLOCKS</p> <p>(1) 7-1/2" x WOF strip; subcut (4) 7-1/2" x 8" rectangles. (1) 3-1/2" x WOF strip; subcut (8) 3-1/2" squares and (4) 1-1/2" x 3-1/2" rectangles. (1) 1-1/2" x WOF strip; subcut (12) 1-1/2" x 3" rectangles.</p>
G		53543-1 Indigo	1/3	<p>PIECED BLOCKS</p> <p>(1) 7-1/2" x WOF strip; subcut (3) 7-1/2" x 8" and (9) 1-1/2" x 3" rectangles.</p>
H		53543-2 Denim	1/3	<p>PIECED BLOCKS</p> <p>(1) 7-1/2" x WOF strip; subcut (3) 7-1/2" x 8" and (9) 1-1/2" x 3" rectangles.</p>
I		53544-1 Indigo	1/4	<p>PIECED BLOCKS: (1) 3-1/2" x WOF strip; subcut (6) 3-1/2" squares and (3) 1-1/2" x 3-1/2" rectangles.</p>
J		53544-3 Light Wash	1/4	<p>PIECED BLOCKS: (1) 3-1/2" x WOF strip; subcut (8) 3-1/2" squares and (4) 1-1/2" x 3-1/2" rectangles.</p>
K		53545-1 Indigo INCLUDES BINDING	1-1/8	<p>PIECED BLOCKS</p> <p>(1) 3-1/2" x WOF strip; subcut (4) 3-1/2" x 4" and (4) 1-1/2" x 3-1/2" rectangles. (1) 3" x WOF strips; subcut (4) 3" x 8" rectangles. (1) 2" x WOF strips; subcut (4) 2" x 8" rectangles. (2) 1-1/2" x WOF strips; subcut (12) 1-1/2" x 3" rectangles.</p> <p>MOTIF BLOCK UNITS</p> <p>(1) 2-1/2" x WOF strip; subcut for</p> <p>STAR: (1) 2-1/2" and (5) 1-1/2" squares. Cut 2-1/2" square diagonally twice to yield (4) QSTs.</p> <p>SHOOFLY: (2) 2-1/4" squares and (4) 1" x 1-3/4" rectangles.</p> <p>CHURN DASH: (2) 2" and (1) 1-1/2" squares and (4) 1" x 1-1/2" rectangles.</p> <p>CROSS: (5) 1-1/2" and (8) 1" squares.</p> <p>BINDING: (8) 2-1/4" x WOF strips.</p>
L		53545-4 Khaki	1-1/8	<p>(2) 3-1/2" x WOF strips; subcut (30) 1-1/2" x 3-1/2" rectangles.</p> <p>SASHING BLOCKS: (13) 1-1/2" x WOF strips. Reserve for strip piecing with A.</p> <p>CORNERSTONES: (3) 1-1/2" x WOF strips. Reserve for strip piecing with A.</p>
		Backing	4-1/2	Batting: 73" x 80"



Field of Tulips

TULIP BLOCK 1

- Flying Geese Unit:** Draw a diagonal line on the wrong side of (1) **A** 1-1/4" square. Place **A** square, right sides together (RST), at the top left corner of (1) **B** 1-1/2" x 3" rectangle. Sew on drawn line. Trim 1/4" away from sewn line. Open and press to reveal **A** corner triangle. Repeat placing (1) **A** 1-1/2" square at the top right corner of the same **B** rectangle. Repeat steps to make a mirror-imaged unit, sewing **A** squares at opposite corners.

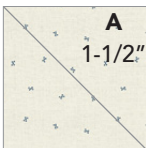
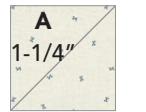

Draw diagonal line on wrong side.



Sew on drawn line. Trim 1/4" away from sewn line.



Open and press to reveal **A** corner triangle. Repeat at opposite corner with **A** 1-1/2" square.



FLYING GEESE UNIT



MIRROR-IMAGED

- Repeat **Step 1** using (2) **A** 1-1/2" squares and (1) **B** 1-1/2" x 3" rectangle.



- Row Unit:** Noting placement of units, sew **Step 1** units to the opposite short sides of **Step 2**'s unit. Then add (1) **A** 1-1/2" x 8" rectangle to the top of row unit.



MIRROR-IMAGED





Field of Tulips

4. **Corner Triangle:** Draw a diagonal line on the wrong side of (1) **A** 2-1/2" square. Place square, RST, at the bottom left corner of (1) **B** 7-1/2" vertical x 8" horizontal rectangle. Sew on drawn line. Trim 1/4" away from sewn line. Open and press to reveal **A** corner triangle. Repeat with another **A** square at the bottom right corner of the same **B** rectangle.



Sew on drawn line.

Trim 1/4" away from sewn line.

Open and press to reveal **A** corner triangle. Repeat at the opposite corner.

5. Repeat **Step 4** using (1) **E** 3-1/2" square and (1) **A** 3-1/2" vertical x 3-3/4" horizontal rectangle, aligning lower right corners. Then draw a diagonal line on the wrong side of (1) **A** 1-1/2" and place at the bottom left corner of the same sewn **E** triangle, as shown. Trim 1/4" away from sewn line. Open and press to reveal **A** corner triangle. Repeat steps to make a mirror-imaged unit.

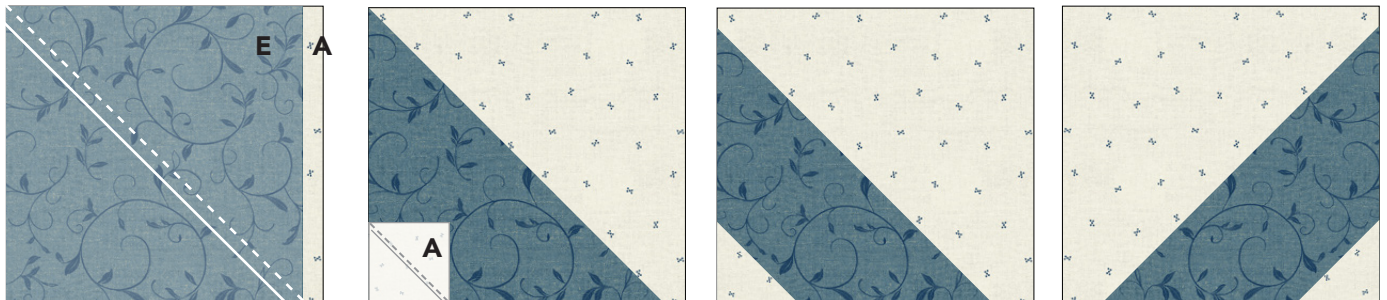

Sew on drawn line. Trim 1/4" away from sewn line.

Open and press to reveal **E** corner triangle. Repeat using **A** square.

MIRROR-IMAGED

6. Sew both **Step 5** units to the opposite long sides of (1) **E** 1-1/2" x 3-1/2" rectangle, as shown.

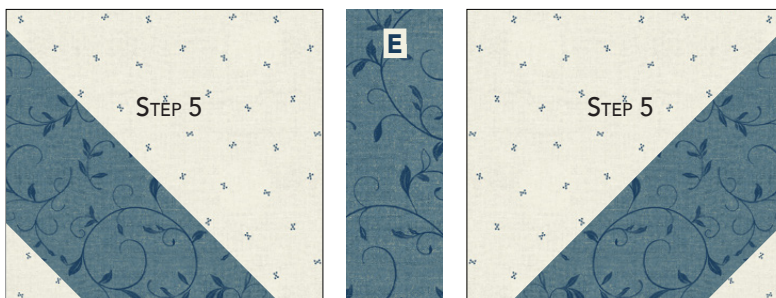



Field of Tulips

7. Sew together units from **Steps 3, 4 and 6** to complete (1) Tulip Block 1. Make (3) of **B/E**. Block measures 8" x 12-1/2" unfinished.

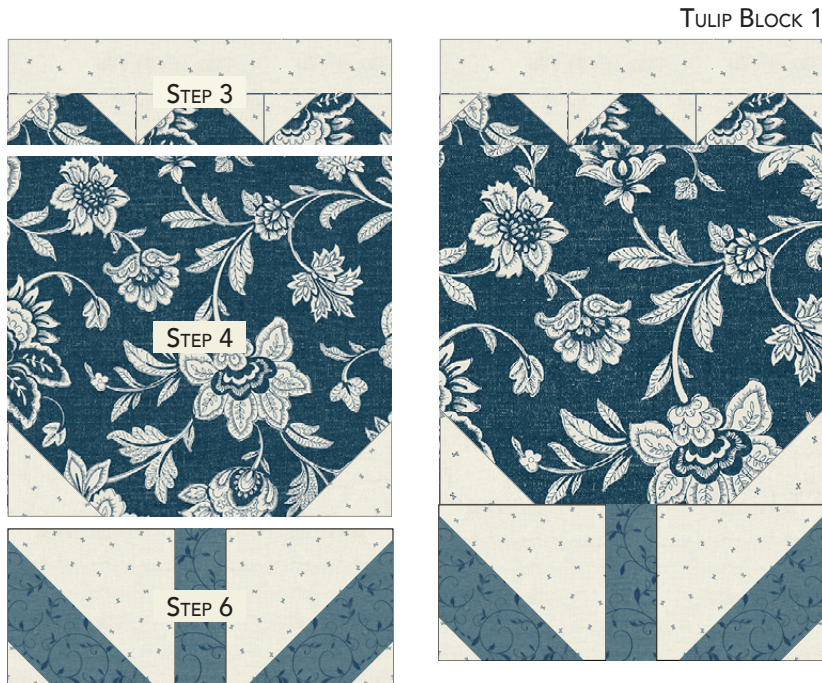

Make (3) of **B/E**
Measures
8" x 12-1/2"
unfinished.

8. Repeat **Steps 1-7** to make a total number of Tulip Block 1 for the following fabric combinations:

Make (3) each.



Make (4)

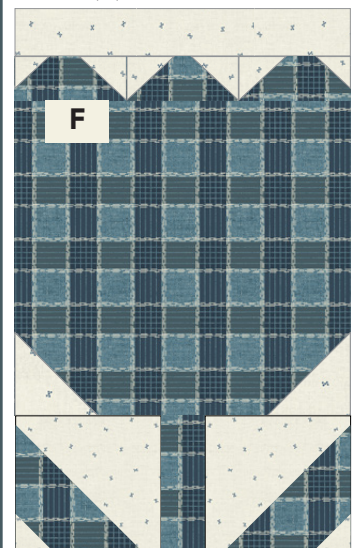



Field of Tulips

SASHING BLOCK

9. Vertical: Sew (2) **A** 1-1/2" x WOF strips to the opposite long sides of (1) **L** 1-1/2" x WOF strip. Make (8) strip sets. Cut strip set at 12-1/2" intervals. Make (24) vertical sashing blocks.

VERTICAL SASHING BLOCK

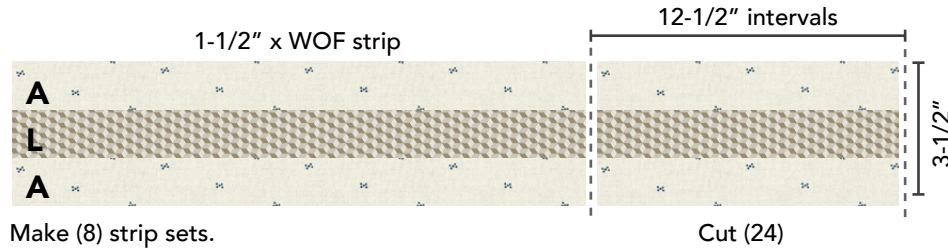

10. Horizontal: Repeat Step 9 to make (5) strip sets. Cut strip set at 8" intervals. Make (25) horizontal sashing blocks.

HORIZONTAL SASHING BLOCK

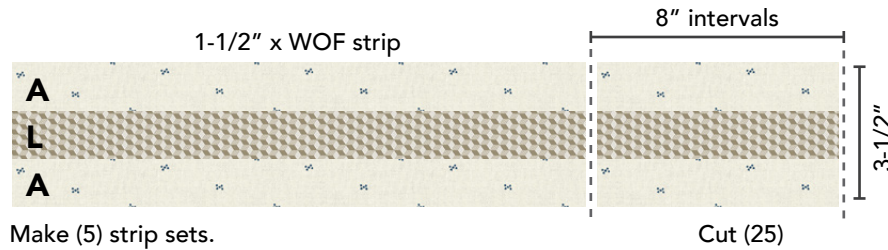

CORNERSTONES

11. Sew (2) **A** 1-1/2" x WOF strips to the opposite long sides of (1) **L** 1-1/2" x WOF strip. Make (3) strip sets. Cut strip set at 1-1/2" intervals. Make a total of (60) units.

12. Noting placement, sew (2) Step 11 units to the opposite long sides of (1) **L** 1-1/2" x 3-1/2" rectangle to make (1) Cornerstone. Make (30), measuring 3-1/2" square.

Step 11

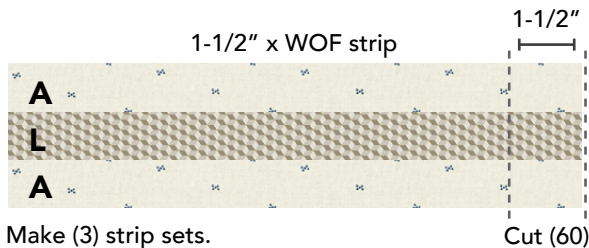

Step 12

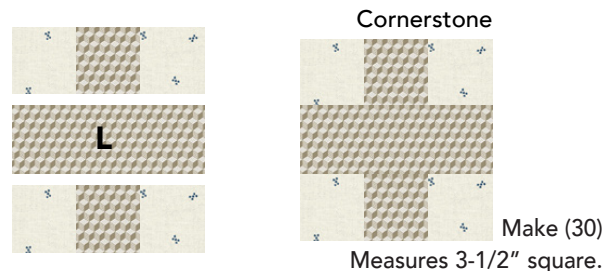



Field of Tulips

TULIP MOTIFS

Shoofly Motif - *Note rotation and placement of units.*

13. Half-Square Triangle (HST): Draw a diagonal line on the wrong side of (1) **A** 2-1/4" square. Place **A** square, RST, on (1) **K** 2-1/4" square. Sew 1/4" away from each side of drawn line to yield (2) HST units. Open and press. Unit measures 1-3/4" square unfinished. Make (4).
14. Sew (2) Step 13 units to the opposite long sides of (1) **K** 1" x 1-3/4" rectangle to make a row unit. Make (2).
15. Sew (2) **K** 1" x 1-3/4" rectangles to the opposite sides of (1) **A** 1" square to make a row unit.

Step 13

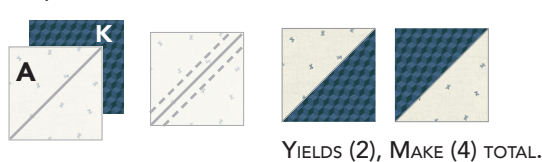

Step 14



Step 15



16. Sew together Steps 14 and 15 to complete Shoofly Motif Unit, measuring 3-1/2" square unfinished.

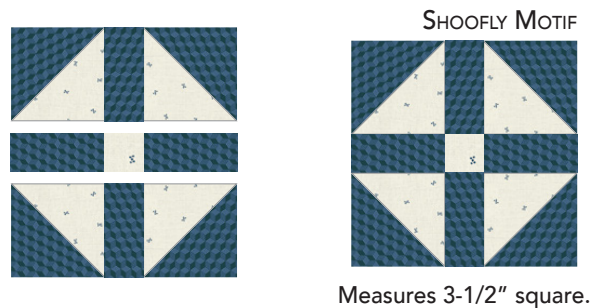

Churn Dash Motif

Note rotation and placement of units.

17. Repeat Step 13 using (2) marked **A** and (2) **K** 2" squares to make (4) HST units. Square up to measure 1-1/2".
18. Sew together (1) **A** and (1) **K** 1" x 1-1/2" rectangles. Make (4).
19. Sew (2) Step 17 units to the opposite sides of (1) Step 18 unit. Make (2) row units.
20. Sew (2) Step 18 units to the opposite sides of (1) **K** 1-1/2" square to make a row unit.

Step 17



Step 18



Step 19



Step 20





Field of Tulips

21. Sew together Step 19 and 20 row units to complete Churn Dash Motif, measuring 3-1/2" square unfinished.

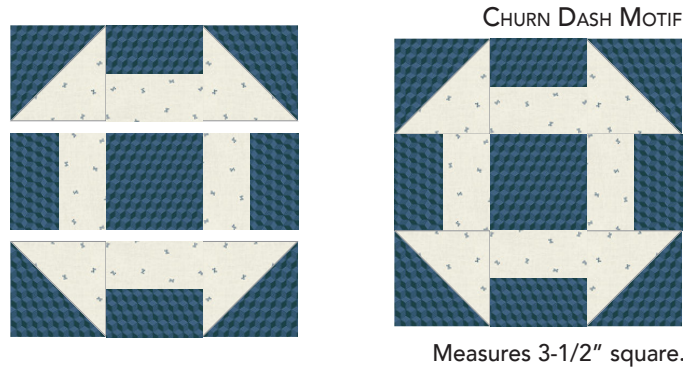

Cross Motif

Note rotation and placement of units.

22. **Corner Triangle:** Repeat Step 4 using (2) marked **K** 1" squares and (1) **A** 1-1/2" square. Make (4).

23. Sew (2) **K** 1-1/2" squares to the opposite sides of (1) Step 22 unit. Make (2) row units.

24. Noting rotation, sew (2) Step 22 units to the opposite sides of (1) **K** 1-1/2" square to make a row unit.

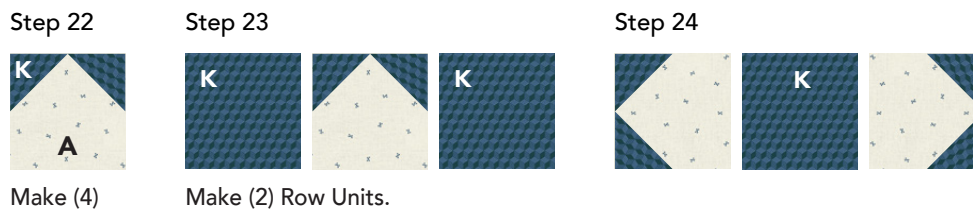

25. Sew together Steps 23 and 24 row units to complete Cross Motif, measuring 3-1/2" square unfinished.

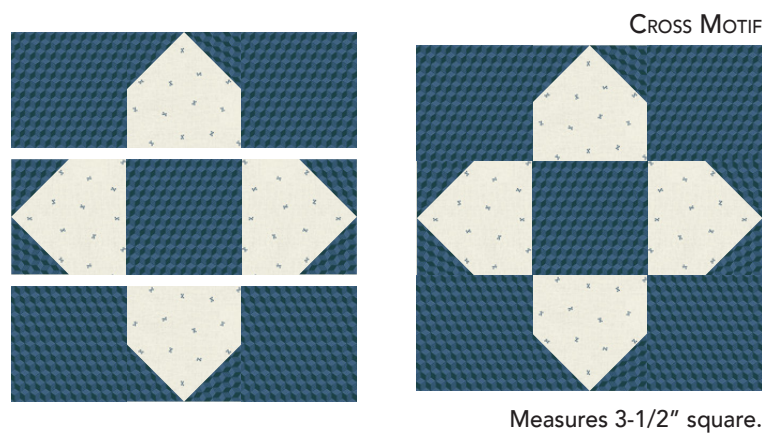



Field of Tulips

Star Motif

Note rotation and placement of units.

26. Sew together (1) **A** and (1) **K** QSTs, followed by (1) **A** HST. Square up to 1-1/2" unfinished. Make (4).
27. Sew (2) **K** 1-1/2" squares to the opposite sides of (1) **Step 26** unit. Make (2) row units.
28. Sew (2) **Step 26** units to the opposite sides of (1) **K** 1-1/2" square to make a row unit.

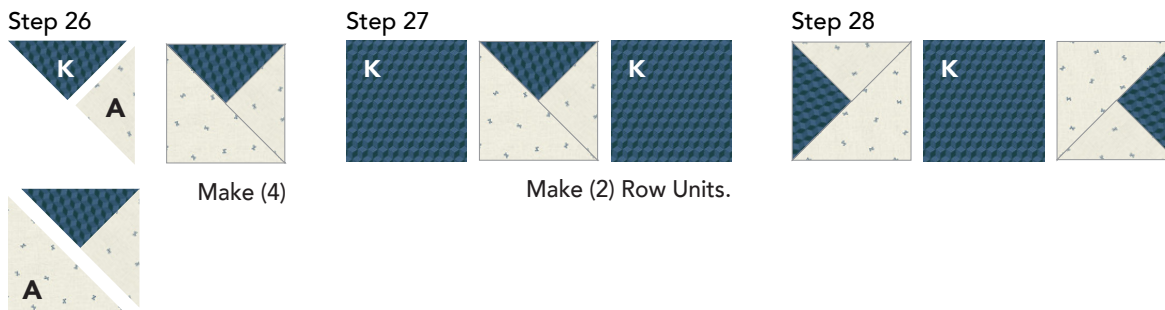

29. Sew together **Step 26** and **Step 27** row units to complete **Star Motif** unit, measuring 3-1/2" square unfinished.

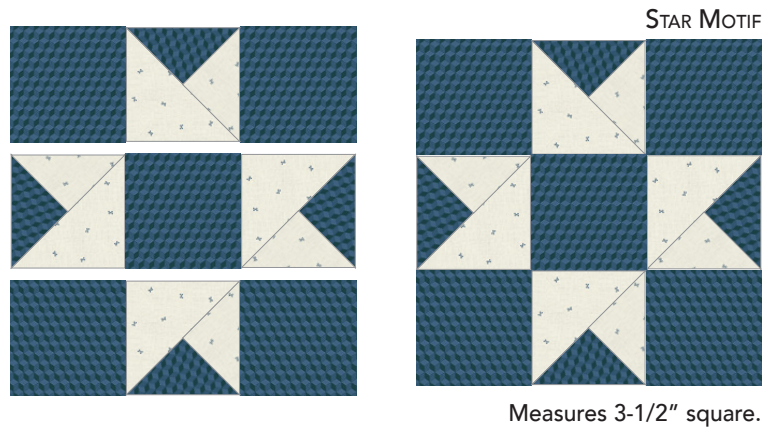

TULIP BLOCK 2 (WITH MOTIFS)

30. Repeat Steps 1-3 to construct the top pieced parts of the Tulip. Use marked **A** and **K** pieces.

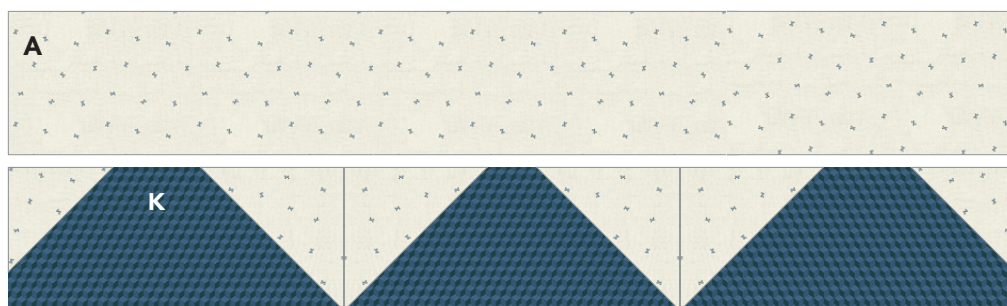



Field of Tulips

31. Add (1) **K** 2" x 8" rectangle to the bottom of Step 30 unit.

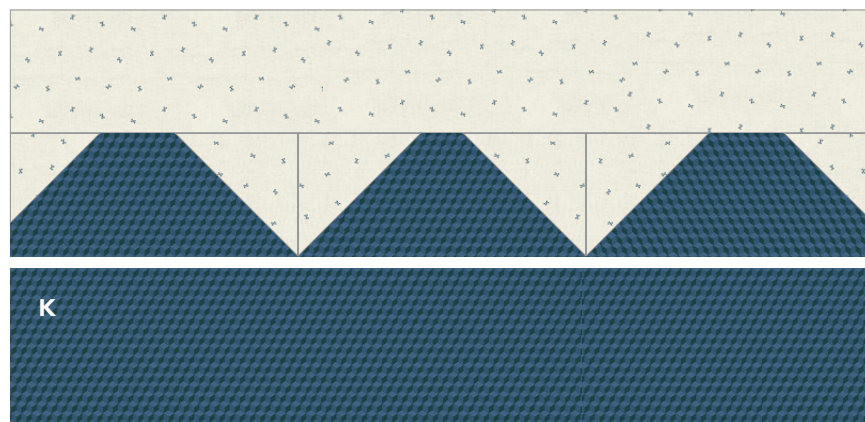

32. Sew (1) **K** 3-1/2" vertical x 4" horizontal rectangle to the left of (1) Churn Dash Motif, and (1) **K** 1-1/2" x 3-1/2" rectangle to make a row unit.

33. Repeat Step 1 using (2) marked **A** 2-1/2" square and (1) **K** 3" x 8" rectangle.

Step 32

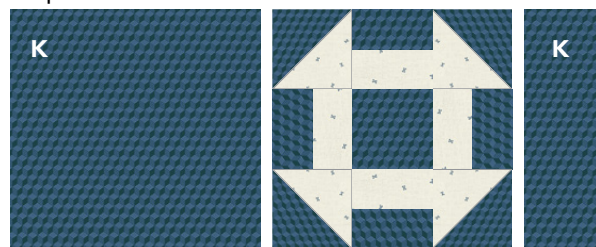

Step 33



34. Repeat Step 5 using (1) marked **J** 3-1/2" square, (1) **A** 3-1/2" x 3-3/4" rectangle, and (1) marked **A** 1-1/2" square to make the leaves. Make a mirror-imaged unit, too.

35. Sew Step 34 units to the opposite long sides of (1) **J** 1-1/2" x 3-1/2" rectangle.

Step 34

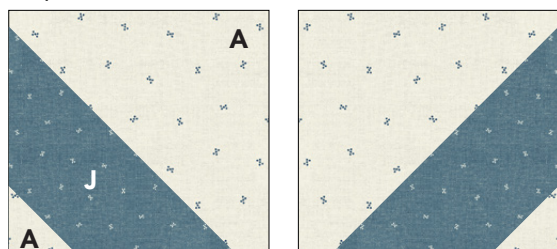

MIRROR-IMAGED

Step 35





Field of Tulips

36. Sew together units made in Steps 31, 32, 33, and 35 to complete (1) Tulip Block 2 (Motif).
Block measures 8" x 12-1/2" unfinished.

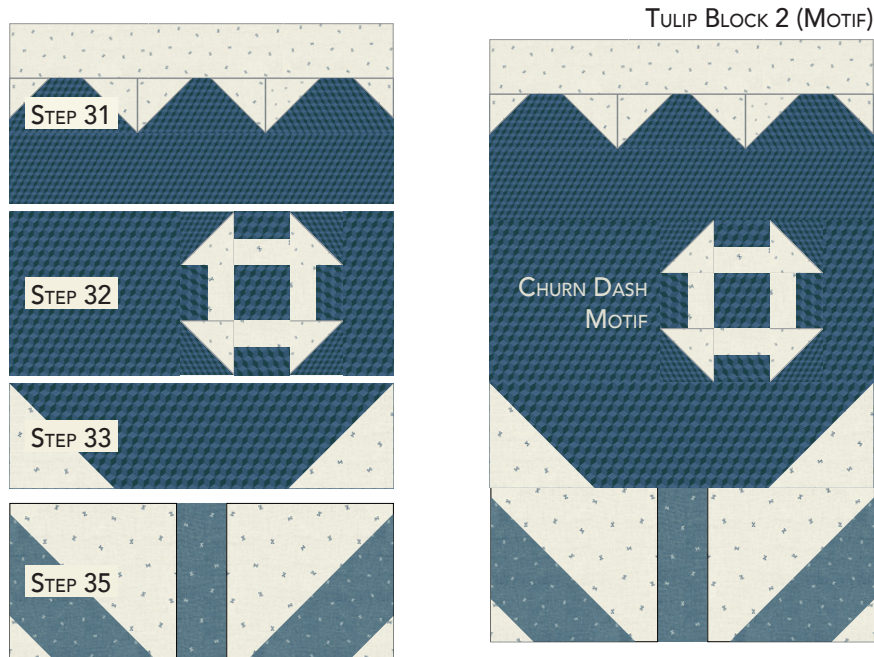

Measures 8" x 12-1/2" unfinished.

37. Repeat Steps 30-36 to make (1) each of the other (3) Tulip Block (Motifs).

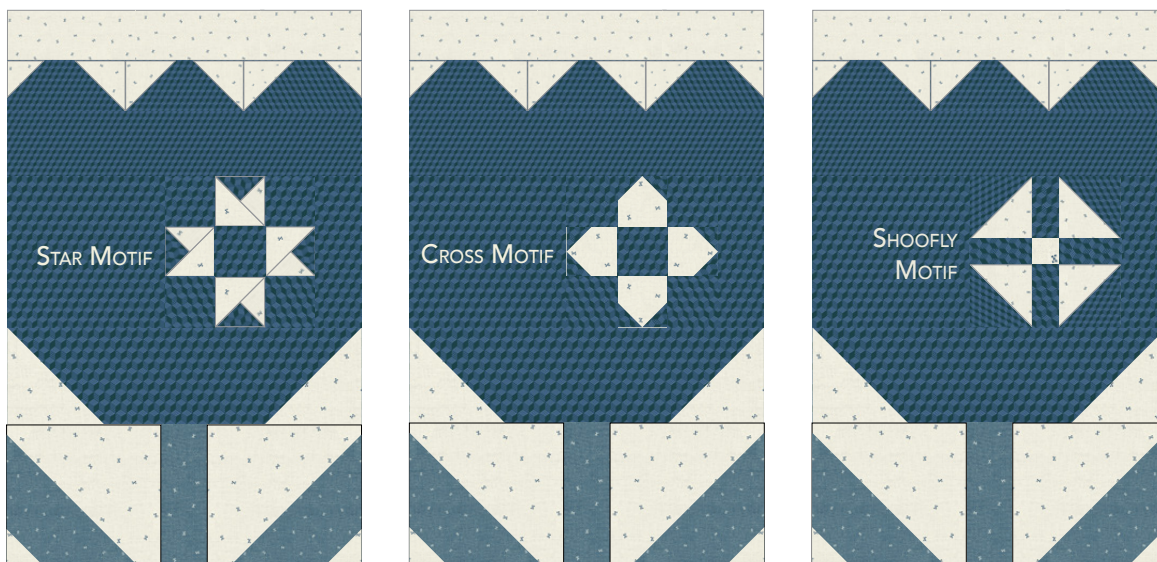



Field of Tulips

Refer to quilt image for block placement.

38. Arrange and sew together (4) Tulip Block 1 and (1) Tulip Block 2 (Motif), alternating with (6) Vertical Sashing Blocks, to make a pieced row. Make (4). Row 1 is shown below.

Row 1



39. Arrange and sew together (6) Cornerstones, alternating with (5) Horizontal Sashing Blocks, to make a pieced sashing row. Make (5).

CORNERSTONE

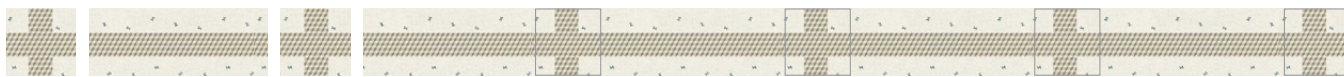

HORIZONTAL SASHING BLOCK

40. Sew together pieced rows, alternating with pieced sashing rows, to complete quilt center.

BORDERS

41. Inner Border: Sew (2) **A** 2-1/2" x 63-1/2" strips to the left and right sides of quilt center, followed by **A** 2-1/2" x 60" strips to the top and bottom of quilt center.
42. Outer Border: Sew (2) **C** 3" x 67-1/2" strips to the left and right sides of quilt center, followed by (2) **C** 3" x 65" strips to the top and bottom of quilt center to complete quilt top.



Field of Tulips

QUILT ASSEMBLY

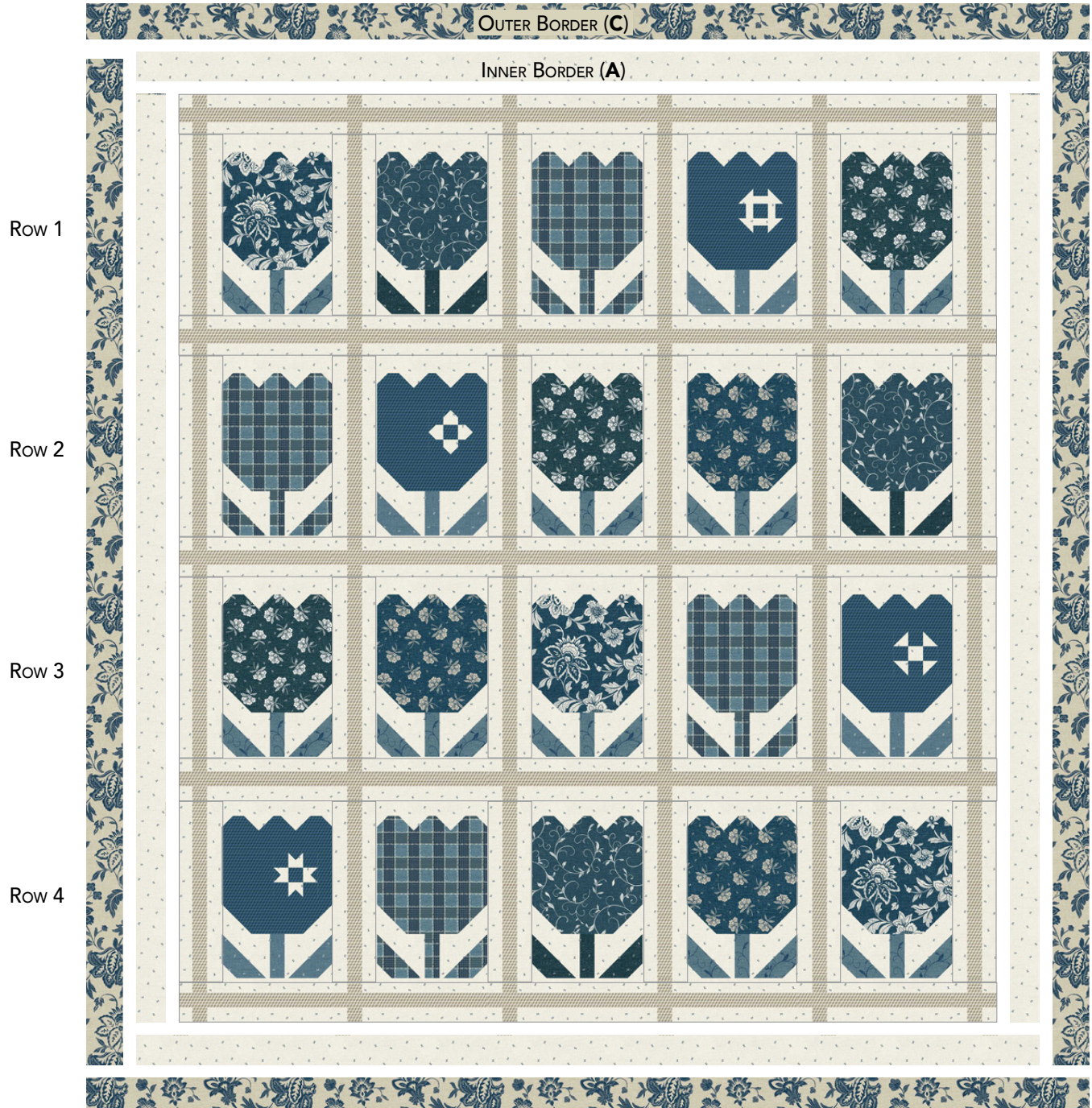

FINISHING: Layer quilt top, batting and backing together to form quilt sandwich. Baste and quilt as desired. Bind using **K** 2-1/4" strips.